

Parking site plans

The pages that follow represent in graphic form the current parking options allowed by city code. Each page shows options using color codes that illustrate where RV's, trailers and other vehicles may be parked. The triangle graphics represent a typical family sedan.

How to use this guide

Lakewood homes are not identical, but there are a limited number of site plans. This guide contains an illustrated page for each of the ten basic site plans. Your home may not look exactly like one of the site plans, but the one most like your home will help you understand the different parking options allowed.

1. The first page is an illustrated index of the pages that follow. Find your lot type on the first page and note the site number (1-10).
2. Go to the page with the site plan that corresponds with the index page's site number most like your home.
3. The color codes and notes in each drawing show different options for on-property parking for that site plan.

Parking site plans

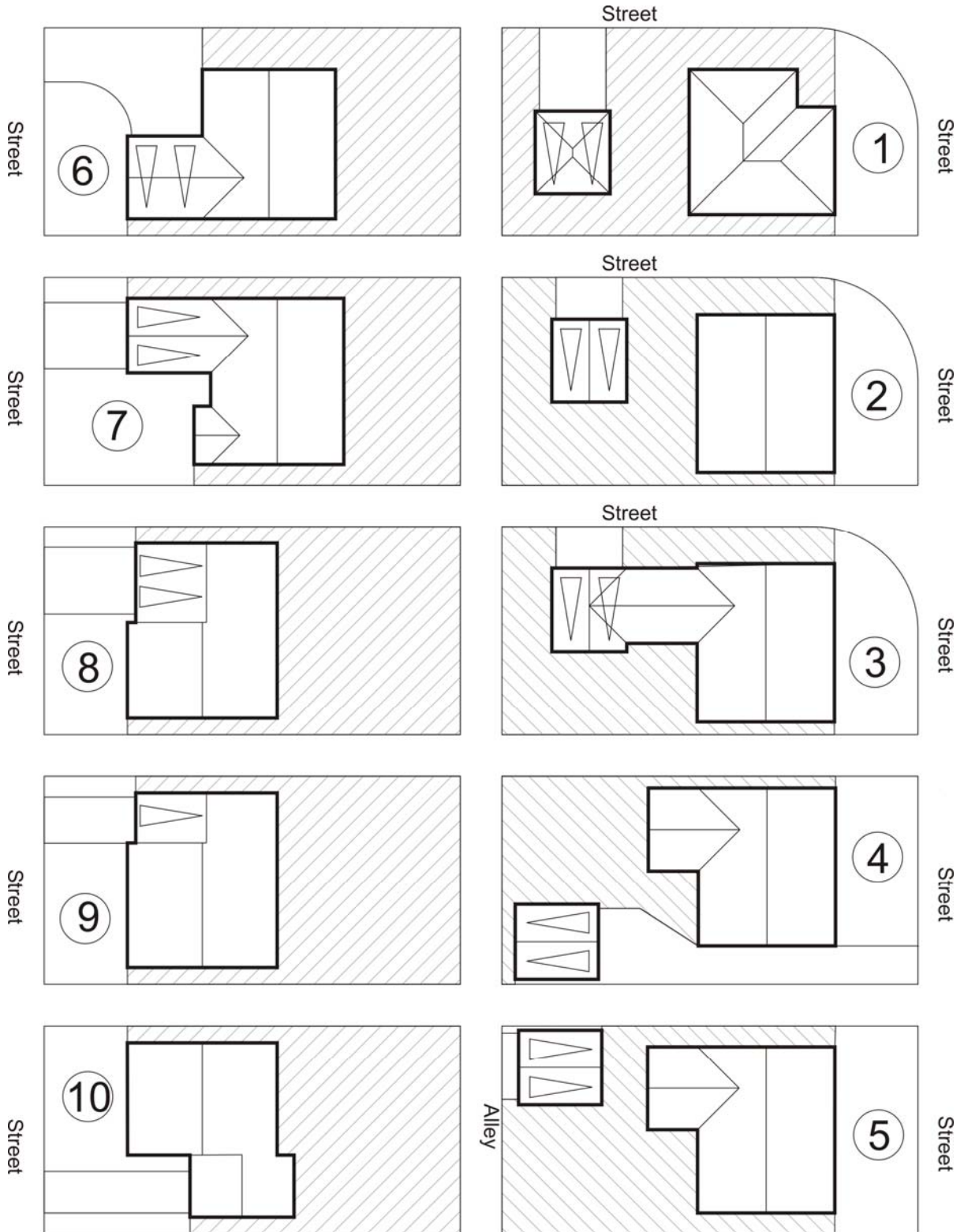

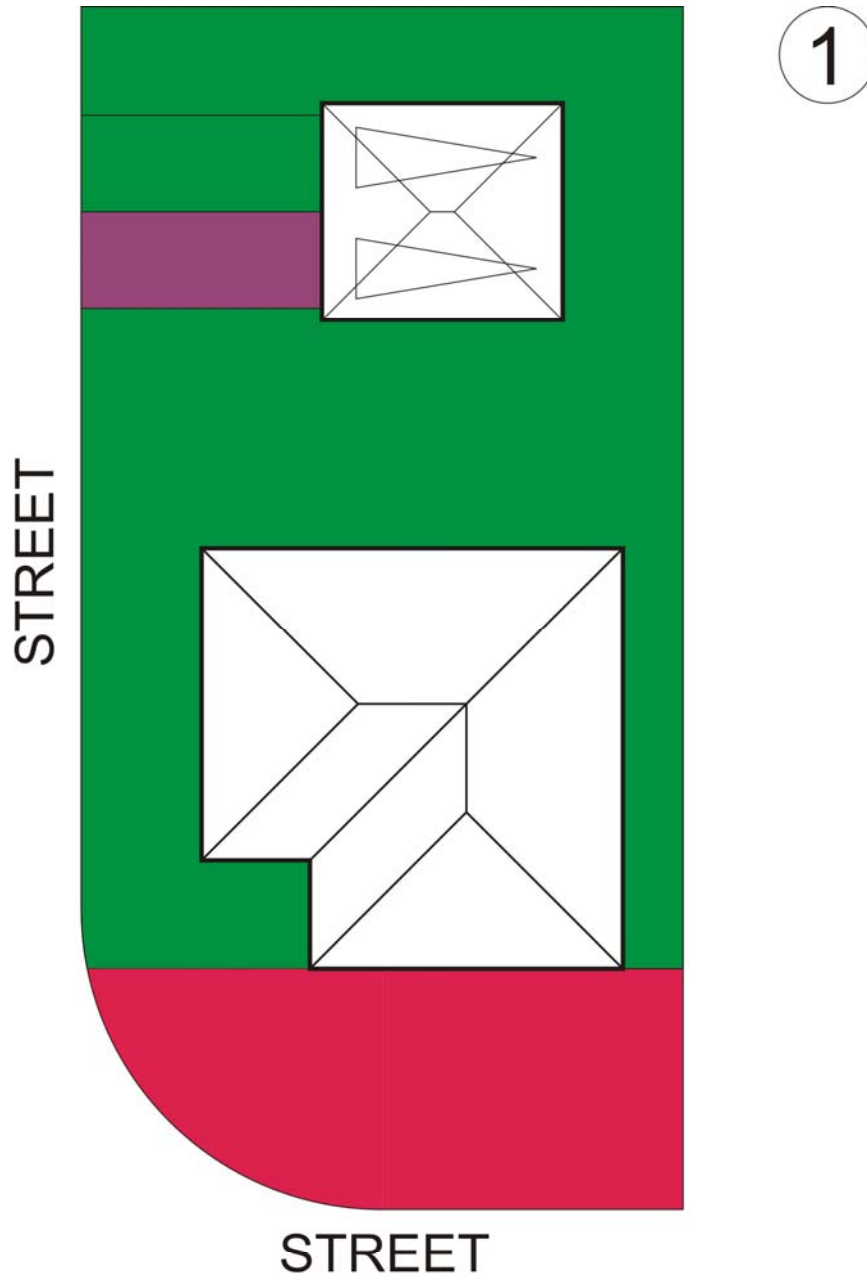

- Storage of RVs and Trailers - Permitted
- Storage of Rvs only - Permitted
- Storage of RVs and Trailers Prohibited
- 72 Hour Parking Only
- Min. of One Off-Street Parking Space (Rvs & Trailers Permitted for 72 Hours for Loading and Unloading)

2

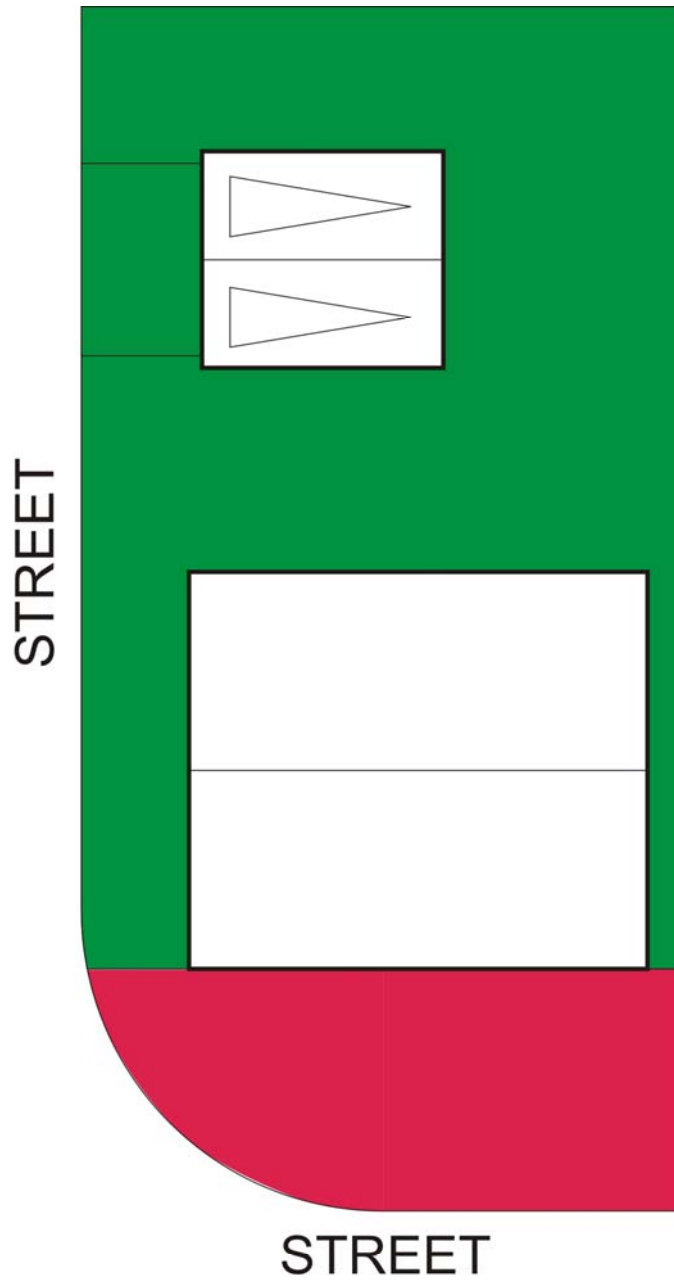

- Storage of RVs and Trailers - Permitted
- Storage of Rvs only - Permitted
- Storage of RVs and Trailers Prohibited
- 72 Hour Parking Only
- Min. of One Off-Street Parking Space (Rvs & Trailers Permitted for 72 Hours for Loading and Unloading)

3

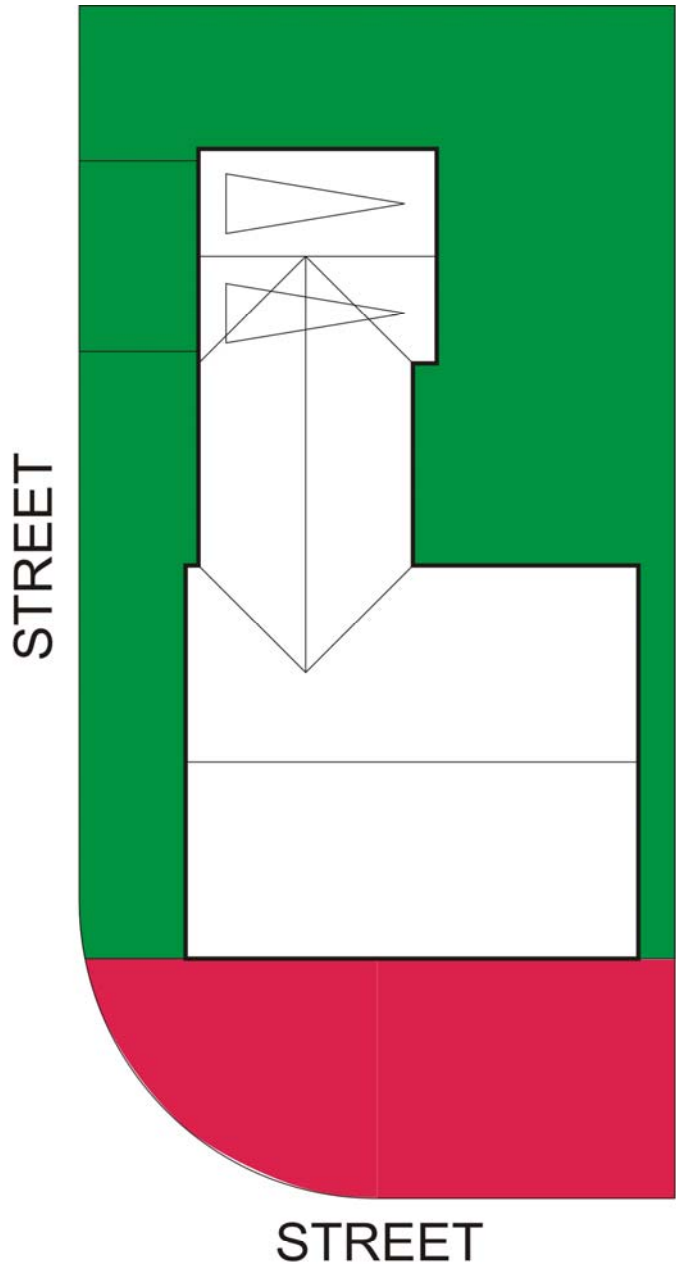

- Storage of RVs and Trailers - Permitted
- Storage of Rvs only - Permitted
- Storage of RVs and Trailers Prohibited
- 72 Hour Parking Only
- Min. of One Off-Street Parking Space (Rvs & Trailers Permitted for 72 Hours for Loading and Unloading)

4

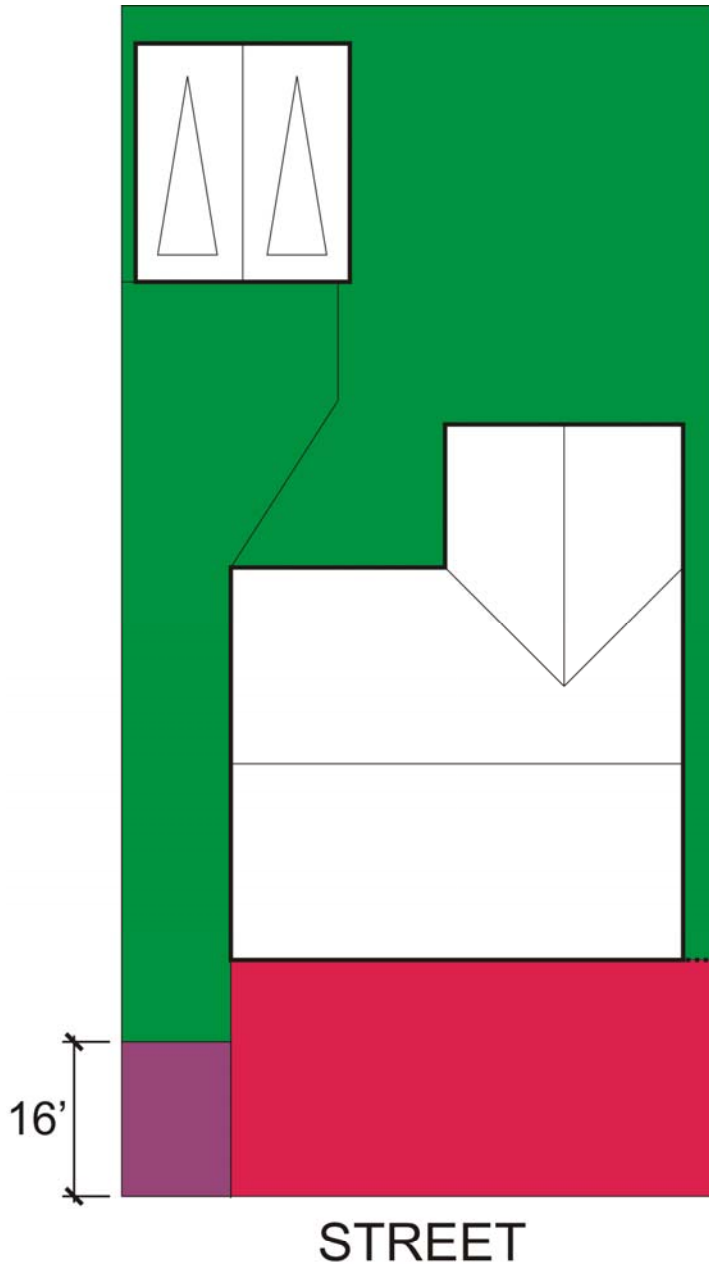

- Storage of RVs and Trailers - Permitted
- Storage of Rvs only - Permitted
- Storage of RVs and Trailers Prohibited
- 72 Hour Parking Only
- Min. of One Off-Street Parking Space (Rvs & Trailers Permitted for 72 Hours for Loading and Unloading)

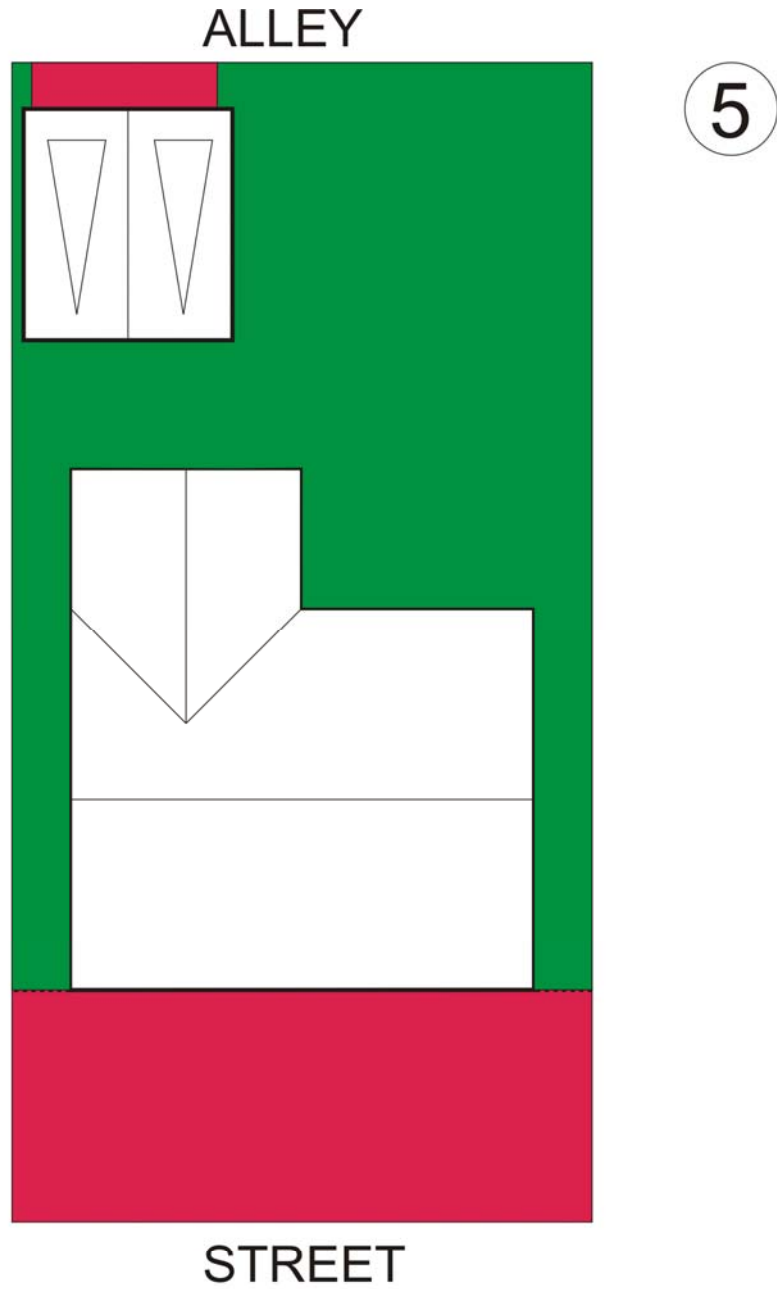

- Storage of RVs and Trailers - Permitted
- Storage of Rvs only - Permitted
- Storage of RVs and Trailers Prohibited
- 72 Hour Parking Only
- Min. of One Off-Street Parking Space (Rvs & Trailers Permitted for 72 Hours for Loading and Unloading)

6

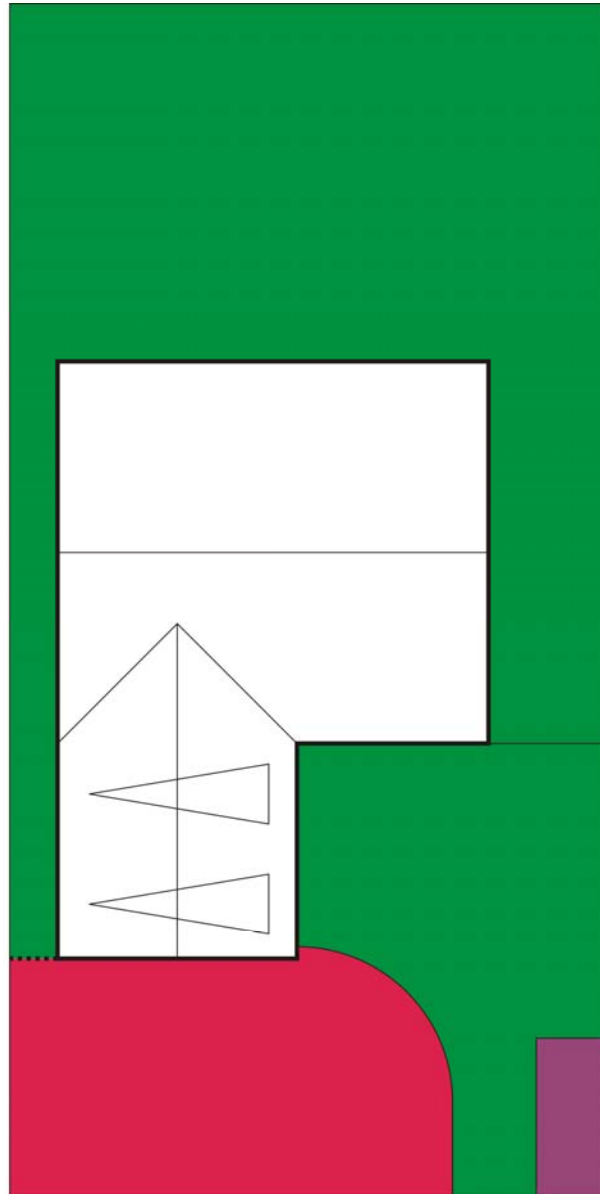

STREET

- Storage of RVs and Trailers - Permitted
- Storage of Rvs only - Permitted
- Storage of RVs and Trailers Prohibited
- 72 Hour Parking Only
- Min. of One Off-Street Parking Space (Rvs & Trailers Permitted for 72 Hours for Loading and Unloading)

7

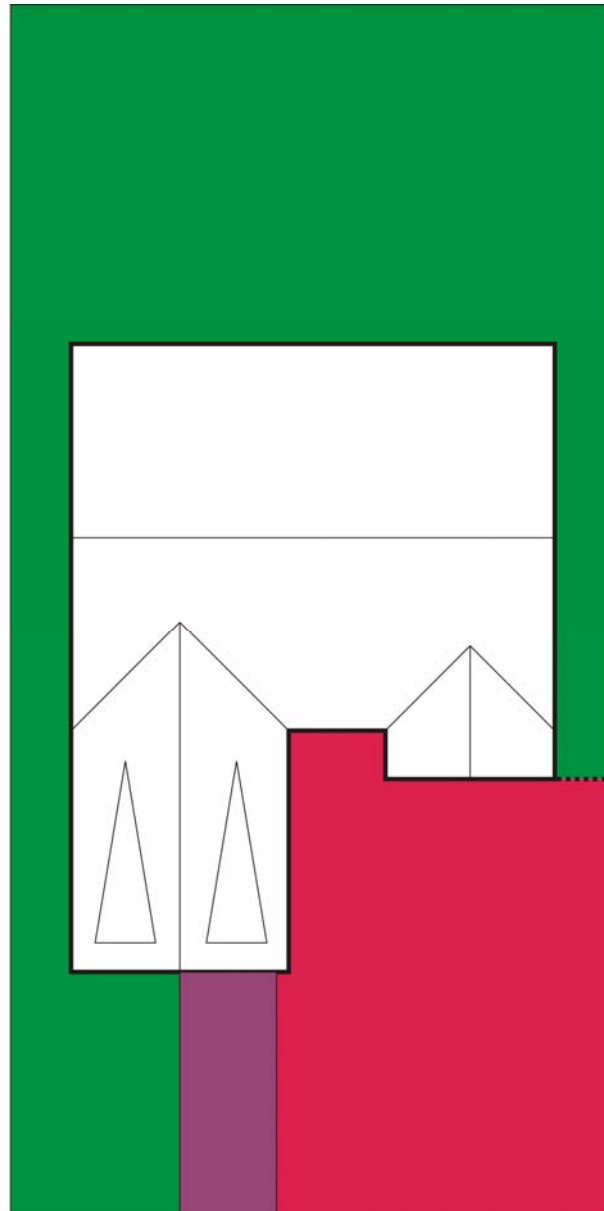

STREET

- Storage of RVs and Trailers - Permitted
- Storage of Rvs only - Permitted
- Storage of RVs and Trailers Prohibited
- 72 Hour Parking Only
- Min. of One Off-Street Parking Space (Rvs & Trailers Permitted for 72 Hours for Loading and Unloading)

8

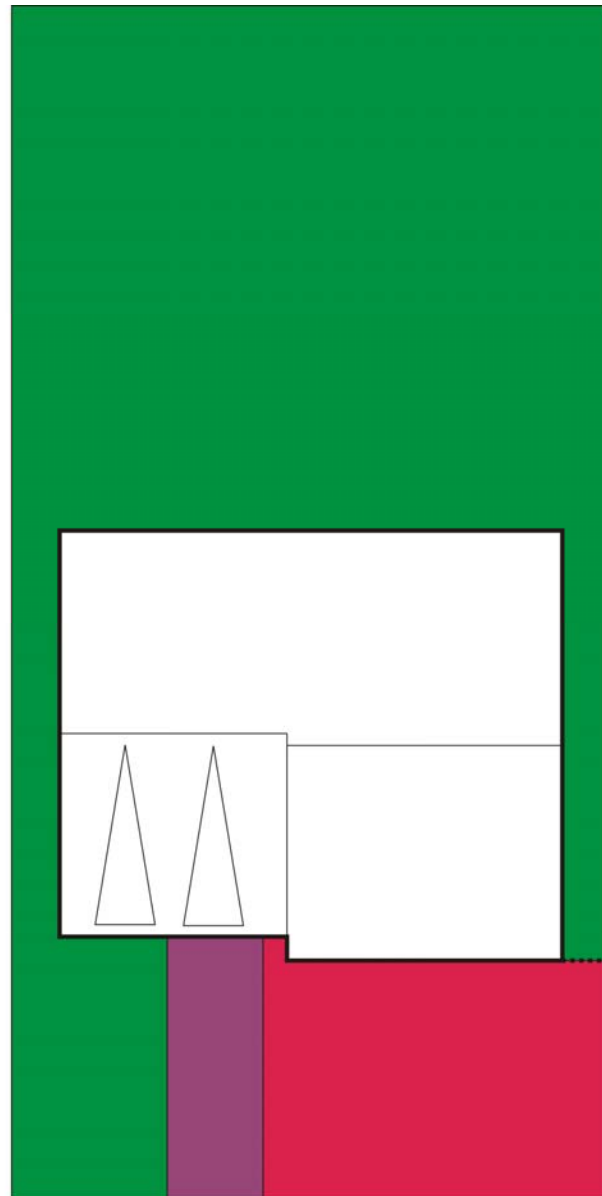

STREET

- Storage of RVs and Trailers - Permitted
- Storage of Rvs only - Permitted
- Storage of RVs and Trailers Prohibited
- 72 Hour Parking Only
- Min. of One Off-Street Parking Space (Rvs & Trailers Permitted for 72 Hours for Loading and Unloading)

9

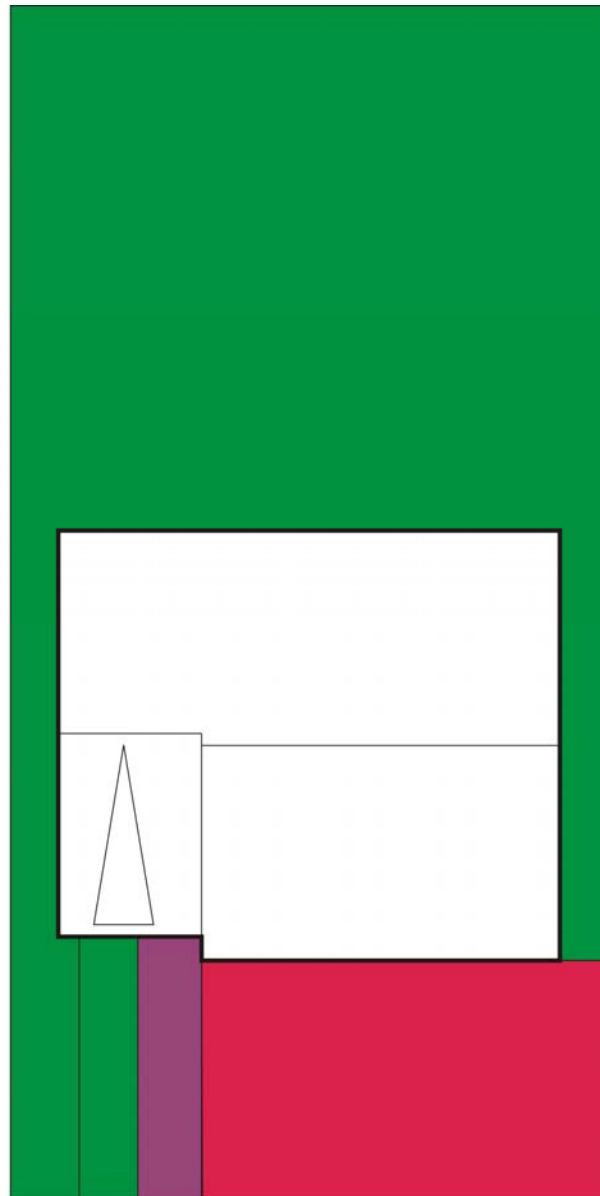

STREET

- Storage of RVs and Trailers - Permitted
- Storage of Rvs only - Permitted
- Storage of RVs and Trailers Prohibited
- 72 Hour Parking Only
- Min. of One Off-Street Parking Space (Rvs & Trailers Permitted for 72 Hours for Loading and Unloading)

10

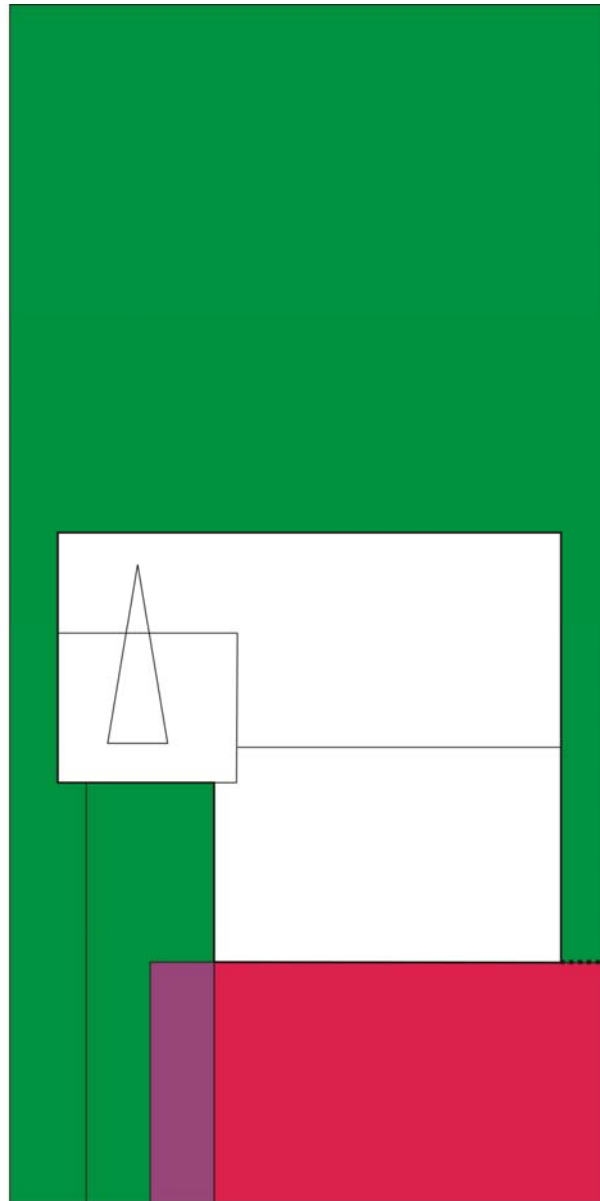

STREET

- Storage of RVs and Trailers - Permitted
- Storage of Rvs only - Permitted
- Storage of RVs and Trailers Prohibited
- 72 Hour Parking Only
- Min. of One Off-Street Parking Space (Rvs & Trailers Permitted for 72 Hours for Loading and Unloading)