

SAMPLE PLOT PLAN

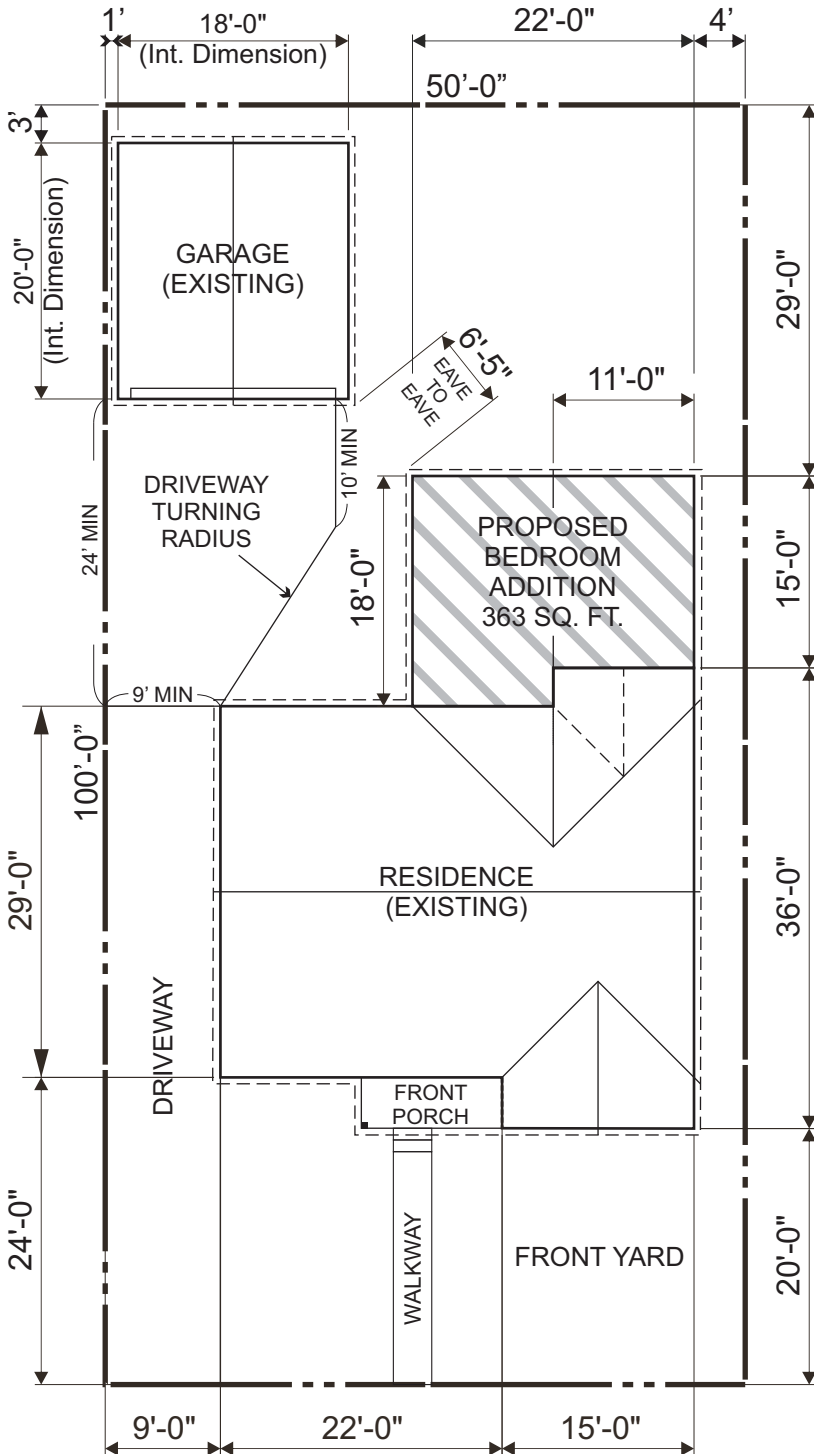

The plot plan submitted for your home improvement project must be drawn on white paper only. The sheet size must be 8½" x 11" or 11" x 17" and must show the following:

1. Location and dimensions of all property lines.
2. Location and size of all existing and proposed structures including the house, garage, patio covers, sheds, exterior water heaters, pools, spas, and air conditioning condensers.
3. Show the front, side, and rear yard setback dimensions and the dimensions of all existing and proposed structures.
4. Location and dimensions of the driveway and minimum turning radius area.
5. The plot plan should be drawn to scale and must show the north arrow. Acceptable scales include 1/16" = 1'-0" and 1" = 20'.
6. The street address and street name should be clearly indicated.
7. For additional information concerning the preparation of a plot plan or requirements, or the City zoning laws pertaining thereto, please contact the Planning Section of the Community Development Department by phone at (562) 866-9771, extension 2341. The Zoning Ordinance is on the City's website - www.lakewoodcity.org.



1234 ANY STREET

1" = 15'-0"